



SELKAS ASANSÖR
MAKİNA ve YEDEK PARÇA

İÇİNDEKİLER

1. GENEL BİLGİLER

1.1 GİRİŞ

2. AÇIKLAMALAR VE ÇALIŞMA PRENSİBİ

3. TEKNİK DETAYLAR

4. GENEL MONTAJ

4.1 GÜVENLİK KONTAKLARININ MONTAJI

5. BOYUTLAR VE AĞIRLIK

6. GERGİ MAKARASININ MONTE EDİLMESİ

7.FRENLEME SONRASI YENİDEN BAŞLATMA

8. ETİKETLEME

9. BAKIM

10. PAKETLEME VE DEPOLAMA

EK-1 REGÜLATÖR KİLİTLEME KAYIT FORMU

11.GARANTİ ŞARTLARI VE SORUMLULUKLAR

1. GENEL BİLGİLER

1.1 GİRİŞ

HIZ REGÜLATÖRÜ KULLANILMAYA BAŞLAMADAN

SLK1-2-3-4-5-6MAKİNE DAİRELİ VE MAKİNE DAİRESİZ(UZAKTAN KUMANDALI)HIZ REGÜLATÖRLERİNİ KULLANIMINA BAŞLANILMADAN ÖNCE KULLANMA KLAVUZUNU DİKKATLİCE OKUYUNUZ.

Ürünümüz**TSEN-81-20** standartlarının tüm gerekenlerini karşılamaktadır.Bununla birlikte ,yanlış montaj veya yanlış kullanım ürününün arızalanmasına neden olabilir.Regülatörler açık havada ve nemli ortamlarda kullanılmamalıdır.

2. AÇIKLAMALAR VE ÇALIŞMA PRENSİBİ

Hız regülatörü kabin nominal hızını aştığında devreye giren bir güvenlik elemanıdır.Eğer asansör kabini yukarı ya da aşağı yönde ilerlerken normal çalışma hızını geçerse regülatör devreye girer ve asansörün elektrik bağlantısını keser,kendi dönüşünü durdurarak kabin üzerinde bulunan fren bloğu mekanizmasını çalıştırır.ve böylece kabin klavuz raylar üzerinde durdurulur.Regülatörün ana parçası olan makarası aşağıdaki gibidir.

(1)Regülatör Kasnağı regülatör halatının üzerinden dolanır ve standartlara uygun olarak üzerinde kanal bulunmaktadır.

(2)Makara yolu

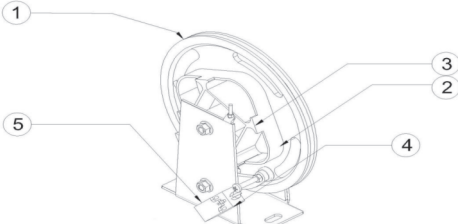

(3)Frenleme dişlileri Regülatör halatı , regülatörün kanal yerinden dolanarak gergi kasnağı

üzerinden geçer ve halat fren bloğuna sabitlenir.Gerdirme sayesinde regülatör üzerinde istenilen basınç uygulanır. Ve 1 nolu kanal üzerine basar.

Regülatör Kasnağı belirli hıza ulaştığında yay kuvvetini yener ve 3 nolu frenleme dişlilerine takılır.Bu sayede regülatör dönüşü durdurulur.

Frenleme işlemini yapmadan önce 5 nolu kontak active edilir. Ve elektrik tertibatı kesilir.

UYARI:

Regülatör ve gergi makaraları birbirini karşılamalıdır.Aksi takdirde mekanik fren olumsuz etkilenir.

A) HIZ REGÜLATÖRÜ (MAKİNE DAİRELİ)

- ▶ Regülatör tarafından uygulanan kuvvet miktarı 300 N dan fazladır.
- ▶ Regülatör üzerinde çalışma yönünü gösteren işaretler vardır.
- ▶ EN 81-2'e göre regülatör halat çapı en az 6mm olmalıdır
- ▶ Halat TSEN 12385-5 ' e uygun olmalıdır
- ▶ Hız regülatörünün halatının kasnaktan kurtulmaması için muhafaza kullanılmıştır.
- ▶ Regülatörlerimizde hız ,seri no,nominal hız ve frenleme hızı değerleri belirtilmiştir.
- ▶ Ve son olarak Regülatör güvenlik kontağının aktif durumda olduğunu kontrol ediniz

B) UZAKTAN KUMANDALI (MAKİNE DAİRESİZ)

- ▶ Regülatör tarafından uygulanan kuvvet miktarı 300 N dan fazladır.
- ▶ Regülatör üzerinde çalışma yönünü gösteren işaretler vardır.
- ▶ EN 81-2'e göre regülatör halat çapı en az 6mm olmalıdır
- ▶ Hız regülatörünün halatının kasnaktan kurtulmaması için muhafaza kullanılmıştır.
- ▶ Regülatörlerimizde hız ,seri no,nominal

hız ve frenleme hızı değerleri belirtilmiştir.

- ▶ Ve son olarak Regülatör güvenlik siviçinin aktif durumda olduğunu kontrol ediniz
- ▶ Güvenlik kontağının her iki yonde tahrik edilir.Elektrik panosundan kontağa uzatılan kablo yardımı ile regülatörün kitlenmesinden sonra
- Kontak üzerindeki pim tekrar ileri itilerek regülatörün çalışma durumuna geri donmesi sağlanır.

TİP	Normal hız (M/S)	Frenleme Hızı (M/S)	Frenleme Tipi (M/S)
SLK-1	0,63	$0,72 < V < 1$	Ani veya Kayma
SLK-3	0,80	$0,92 < V < 1$	Ani veya Kayma
SLK-2	1,00	$1,15 < V < 1,50$	Ani veya Kayma
SLK-4	1,20	$1,38 < V < 1,70$	Ani veya Kayma
SLK-5	1,60	$1,85 < V < 2,15$	Ani veya Kayma
SLK-6	0,40	$0,46 < V < 0,80$	Ani veya Kayma
Rulmanlar	2x Rulman		
Çalışma Yönü	Aşağı ve Yukarı		
Gergi Ağırlığı	16-17KG		
Halat çapı	6-8mm		
Kasnak Çapı	300-210mm		
Fren Blok Tipi	Ani veya Kayma		

4. GENEL MONTAJ

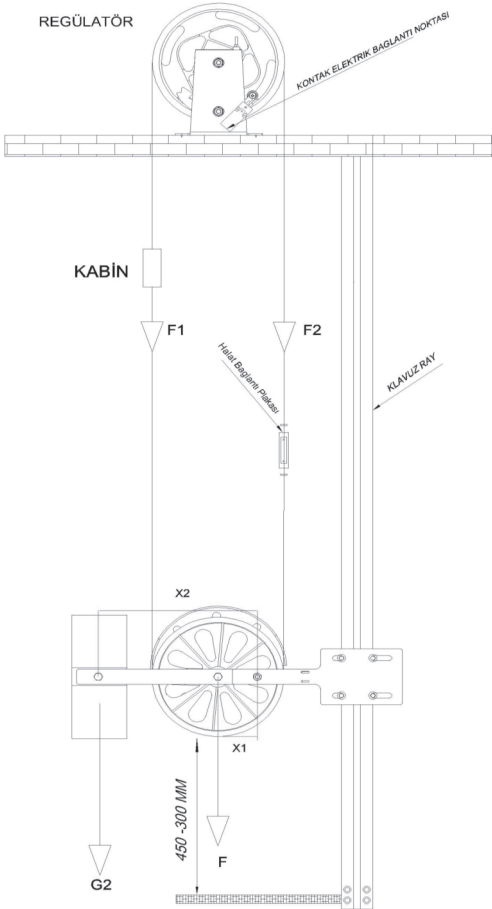

4.1.GÜVENLİK KONTAKLARININ MONTAJI

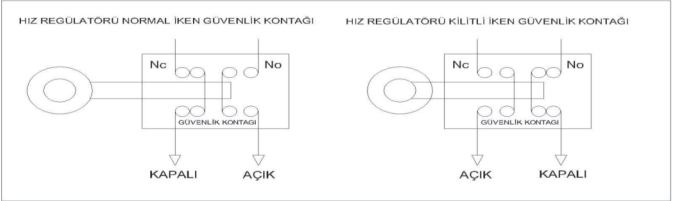

Güvenlik Kontaktlarının montajı:

Montaj yapılmadan önce asansörün tüm elektrik tesisatı devre dışı bırakılmalıdır. Güvenlik kontaktarı eğitimli teknisyenler tarafından monte edilmelidir. Güvenlik kontak kabloları ilgili satıncılara uygun olarak seçilmelidir.

5 . BOYUTLAR VE AĞIRLIK

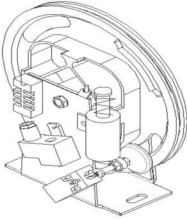

TİP : SLK-0/M
AĞIRLIK : 12 KG

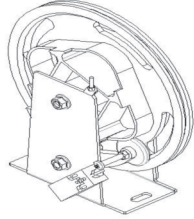

TİP : SLK-0
AĞIRLIK : 12 KG

SELKAS ÜRÜNLERİ CE BELGELİ VE KALİTE KONTROLÜ SAĞLANMIŞTIR

6.GERGİ MAKARASININ MONTE EDİLMESİ

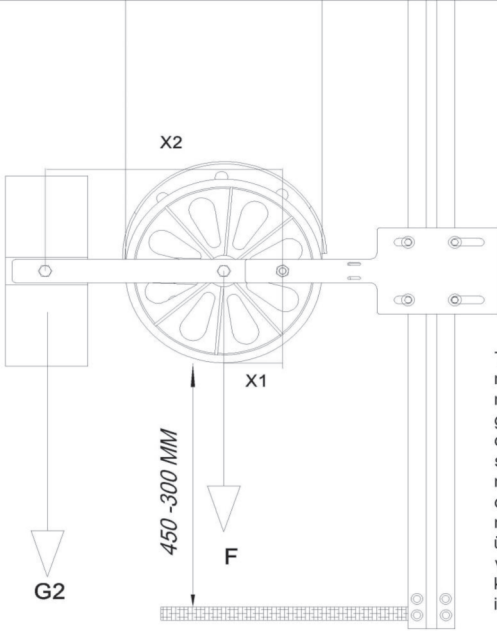

Tavsiye edilen gergi makarasının montaj resiminde görüldüğü gibidir. Tek ve çift şekilde bağlanabilir. min. ağırlık 16 Kg olmalıdır Hareketli mekanizmanın üzerinde bulunan vida ve somun gibi kontrolü elemanlar iyice sıkılmalıdır.

7. FRENLEME SONRASI YENİDEN BAŞLATMA

Regülatör frenleme yapınca aşağıdaki işlemler yapılmalı ve sistem yeniden başlatılmalıdır.

- 1 – Asansör makinasını frenleme yönünden aksi tarafına mekanik frenden kurtuluncaya kadar el ile veya elektrikli el ile kurtarma ile çeviriniz.
- 2 – Mekanik freni ve regülatörü kilitleme pozisyonundan kurtulduğundan emin olunuz
- 3 – Regülatör güvenlik kontağını normal konumuna getiriniz. Eğer kilitli alt regülatör kontağını normal konumuna getiriniz
- 4 – Regülatör yivini halatlarını mekanik fren bağlantılarını kontrol ediniz.

8. ETİKETLEME

- Selkas Regülatör üzerinde 2 adet etiket bulunur .
- A ; Güvenlik kontak şemasını gösterir.
- B ; Regülatör tipini, seri numarasını seyahat hızını ve kilitleme Hızını gösterir

9 . BAKIM

SELKAS Regülatörü EN 81 -1 ve 81 - 2 standartlarına göre en az 20 kez kilitlemeye karşı garantilidir.

Regülatörün çalışabilir durumda olduğunu onaylamak için her yıl aşağıdaki kontroller yapılmalıdır.

- 1 – Halatı uzamaya ve aşınmaya karşı kontrol edin
- 2 – Halatı ve mekanik fren bağlantılarını kontrol edin
- 3 – Halatın bozulmasını engellemek için regülatör yivinin temiz olduğunu kontrol edin
- 4 - Regülatör halatının yağlı olmamasına dikkat edin, eğer yağlanmışsa temizleyin
- 5 - Deformasyon olduğu takdirde regülatörü kullanmayın. Regülatör tamir etmeyi veya parçalarını değiştirmeyi denemeyin. Tüm işlemler sadece üretici tarafından yapılır. Aksi takdirde üretici firma regülatörden gelebilecek herhangi bir fiziksel, somut veya soyut zarardan sorumlu değildir.

10. PAKETLEME VE DEPOLAMA

- * Regülatör karton kutuda teslim edilmektedir .
- * Paket boyutları : 340mm x 140mm x 380mm
- * Paket ağırlığı : 12kg.
- * Regülatör tipi ve çalışma hızı paket üzerinde belirtilmiştir
- * Regülatör nem ve tozun olmadığı kapalı ortamlarda depolanmalıdır.
- * Ürünün Eksiksiz olduğuna dikkat ediniz.

11)GARANTİ ŞARTLARI VE SORUMLULUKLAR

SLK 1-2-3-4-5-6 EN 81-1 VE EN 81-2 standardı dahilinde en az 50 kez kilitlenmeye karşı garantilidir.

Ayrıca kullanım kılavuzunda belirtilen şartlar içerisinde 2 yıl garantilidir.

Aşağıda bulunan durum ya da birkaçına bağlı olarak oluşabilecek maddi manevi olarak

SELKAS ASANSÖRsorumlu değildir.

Kullanım kılavuzu veya standartlara aykırı montaj yapılması

frenleme hızının değiştirilmesi veya mührün bozulması oynanması gibi durumlarda

Beyanımızın dışında kullanılması

Dış etkilere bağlı oluşan hasar durumunda

GÜVENLİK UYARILAR :

Regülatörün montaj kuralları montajı yapan firmaya aittir.Hız regülatörleri asansörde güvenlik ekipmanları sınıfına girer.Güvenlik elemanlarının montajı ve kullanımı özel itina ve tecrübe gerektirir.Yanlış montajı yapılan hız regülatörü ve gergi kasnağı sonucunda oluşan hatalardan maddi manevi **SELKAS ASANSÖR** asla sorumlu değildir.



SELKAS ASANSÖR

MAKİNA ve YEDEK PARÇA

I N D E X

1.GENERAL INFORMATIONS

1.1.INTRODUCTION

2.EXPLANATIONS AND WORKING PRINCIPLE

3.TECHNICAL DETAILS

4.GENERAL ASSEMBLY

4.1.HOW TO ASSEMBLY SAFETY CONTACT

5.DIMENSIONS AND WEIGHT

6)MOUNTINGOF TENSIONPULLEY

7)RESTART AFTER TO BRALCE

8)LABELING

9)CARE

10)PACKING AND STORAGE

ANNEX LOCKING OF OVERSPEED GOVERNOR AND REGISTRATION

FORM

11.WARRANTY TERMS AND RESPONSIBILITIES

GENERAL INFORMATION

1.1 INTRODUCTION

PLEASE READ THIS USER GUIDE CAREFULLY BEFORE STARTING USE
SLK 1-2-3-4-5-6, WITH MACHINE ROOM AND MACHINE ROOMLESS (REMOTE
CONTROL)

Our product meets all requirements of TSEN-81-20 Standards. However, incorrect installation or cause a malfunction of the product operability block may be wrong. Therefore, the installation must be done carefully and diligently. Overspeed Governors should not be used outdoors and in humid environments

2. EXPLANATIONS AND WORKING PRINCIPLE

Overspeed governor is a safety fixings which works when the cabin passes the normal velocity. If the elevator car moves up or down direction exceeds the normal operating speed, the overspeed governor is engaged in and lift off the supply. It stops rotating and runs the brake mechanism on the elevator car. So the elevator car is stopped on the guide

Rails. The pulley main part of the regulator is as follows
(figure 1)

- (1) Pulley of overspeed governor wanders out of the governor rope and has a channel according to standards
- (2) Roller way

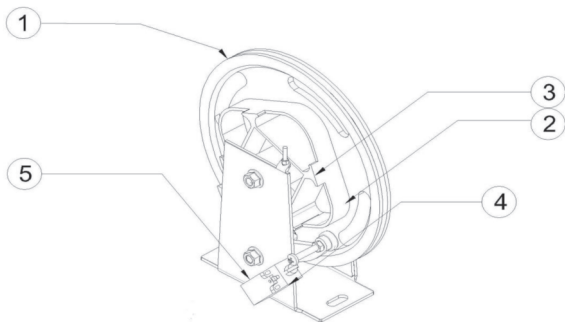

(3) Brake blockers; Rope of overspeed governor, passes on tension pulley, by move around the channel and fixed to the brake block. Desired pressure is applied by means of stretching and the rope is in channel 1

The overspeed governor overcomes the force of the spring when it reaches to certain speed, than locked in brake blockers.

The overspeed governor overcomes the force of the spring when it reaches to certain speed and it is locked and the overspeed governor is locked The contact is activated and the electricity cut before braking

CAUTION;

Overspeed governor and tension pulley must be suitable for each other's, otherwise the mechanical brake is adversely affected

3 TECHNICAL DETAILS

A) OVERSPEED GOVERNOR (WITH MACHINERY ROOM)

- ▶ The amount of force applied by the overspeed governor is greater than 300 N.
- ▶ There are signs indicating the direction of working on the overpeeed governor.
- ▶ The diameter of the rope must be minimum 6mm accord to EN - 1, EN 81-2
- ▶ A protection was used on the overspeed governor, in order not to get of the rope from the channel.
- ▶ Speed, serial number, nominal speed and braking rate values are indicated on the overspeed governor.
- ▶ And last, please check the safety contacts, it must be active.

B) REMOTE CONTROL (MACHINE ROOMLESS)

- ▶ The amount of force applied by the overspeed governor is greater than 300 N.
- ▶ There are signs indicating the direction of working on the overpeeed governor.
- ▶ The diameter of the rope must be minimum 6mm accord to EN 81-,EN 81-2
- ▶ A protection was used on the overspeed governor, in order not to get of the rope from the channel.
- ▶ Speed, serial number, nominal speed and braking rate values are indicated on the overspeed governor.
- ▶ And last, please check the safety switch, it must be active
- ▶ Of safety switches are driven in either direction. With the help of extended cable from the switch to the electrical panel locked after the overspeed governor, the pins on the contact pushed forward again to return to work status of the overspeed governor is provided.

TYPE	Nominal Speed (M/S)	Braking Speed (M/S)	Braking Type (M/S)
SLK-1	0,63	$0,72 < V < 1$	Sudden or Slide
SLK-2	0,80	$0,92 < V < 1$	Sudden or Slide
SLK-3	1,00	$1,15 < V < 1,40$	Sudden or Slide
SLK-4	1,20	$1,40 < V < 1,70$	Sudden or Slide
SLK-5	1,60	$1,85 < V < 2,15$	Sudden or Slide
SLK-6	0,40	$0,46 < V < 0,80$	Sudden or Slide
Bearings	2x Bearing		
Work Direction	Up and Down		
Tension Weight	16-17 Kg		
Rope Diameter	6-8mm		
Type of Brake Block	Sudden or Slide		
Pulley Diameter	210mm-300mm		

4.GENERAL ASSTMBLY

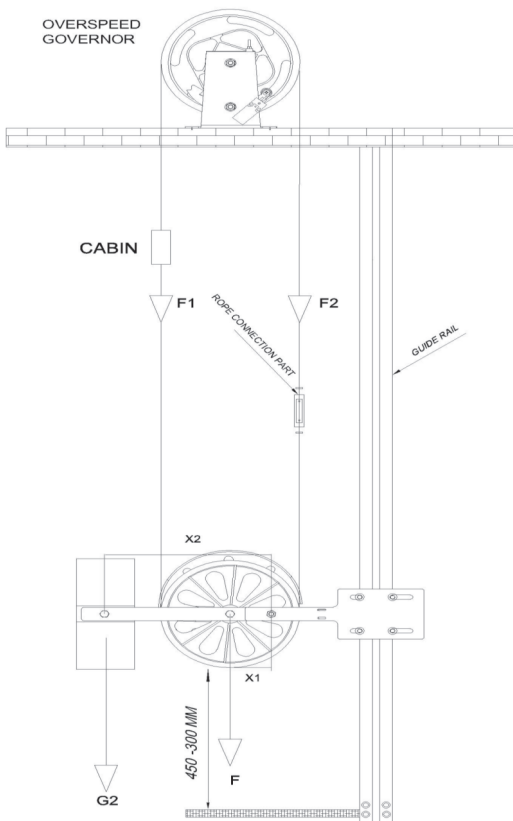

4.1. HOW TO ASSEMBLY SAFETY CONTACT

SAFETY CONTACT SITUATION WHEN OVERSPEED
OVERSPEED GOVERNOR OPARATES NORMALLY

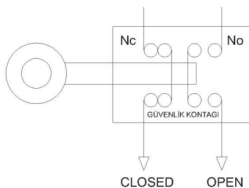

SAFETY CONTACT SITUATION WHEN OVERSPEED
OVERSPEED GOVERNOR LOCKED POSITION

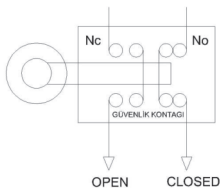

Installation of Security Contacts

All electrical wiring must be disabled before mounting the lift.

Safetycontacts should be installed by trained technicians.

Safety contact cables must be selected in accordance with the relevant standards.

5.DIMENSIONS AND WEIGHT

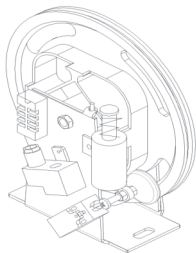

TYPE : SLK-()/M Overspeed Governor
Machine Roomless

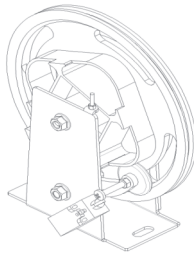

TYPE : SLK-() Overspeed Governor
With Machine Room

Dimensions Of Selkas Overspeed Governors

6.MOUNTING OF TENSION PULLEY

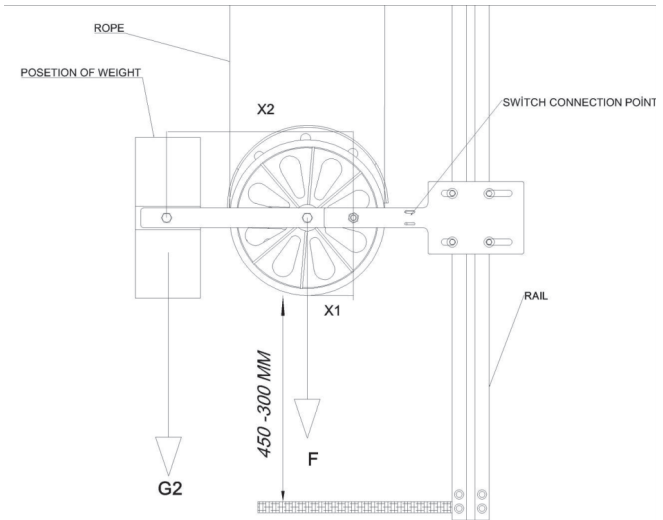

The mounting of tension pulley is like in the picture There are two kinds of connection style as single and double and min weight must be 16 kgs
Nuts and screws on the moving parts,must be Tightened

7.RESTART AFTER TO BRALCE

Braking,the following operations must be done when you have made the regulator and the must be restarted.

- 1.Turn the machine pulley to unbrace directron by hand or electric,untrll unbracing.
- 2.Be sure that the mechanical brake is unlock position
- 3.Take the safety contact and locked contact of tension pulley to normal position.
- 4.Check the groove of overspeed,rope and connection of mechanical brake

Selkas's products are CE certified and quality control is provided.

8 . LABELING

Two label is located on Selkas overspeed governor.

A ; Drawing of safety contact

B ; Regulator type, the serial number of the travel speed and the maximum speed of the locking

9 .CARE

According to the standards EN 81-1 and 81-2 overspeed SELKAS at least 20 times are warranted to lock.

To confirm that the regulator is in operating condition, the following checks should be made each year.

- 1 – Check the rope elongation and abrasion
- 2 – Check the connection of the rope and mechanical brakes
- 3 – Check that the regulator in order to prevent distortion of the rope groove cleaner
- 4 - Make sure the regulator is not greasy rope, if you clean lubricated
- 5 - Do not use in case of deformation regulator. Do not attempt to repair or change parts of the overspeed governor. All transactions are made only by the manufacturer, .
Otherwise, the regulator can manufacturer any physical, tangible or intangible is not liable for damages

10. PACKING AND STORAGE

- * The regulator is supplied in cardboard packaging.
- * Packagedimensions: 340 mm x 140 mm x 380 mm
- * Package weight12 kg.
- * The regulator statedn the package type and working speed
- * The regulator should be stored in closed environments, moisture and dust does not.

11 . WARRANTY TERMS AND RESPONSIBILITIES

SLK-1-2-3-4-5-6 deadlock is guaranteed against at least 50 times in EN81-1 and EN 81-2 Standards In addition, under conditions specified in the user manual 2 years warranty One or more of the following situations may occur depending on the material and spiritual issues **SELKAS ASANSÖR** is not responsible

User manual assembly or one contrary to standards
Braking rate or seal to be replaced such as corrosion cases
Declared use outside of speed
In case of damage due to external factors consisting

SAFETY PRECAUTIONS

Overspeed governor assembly rules, making the installation belongs to firm's
Overspeed governors are in the category of safety equipment in the require special care and experience incorrect installation of the speed overspeed governor and tension pulley resulting from errors material and spiritual ,our company is not responsible for never.



AT UYGUNLUK BEYANI

EC DECLARATION OF CONFORMITY

Company Name : SELKAS ASANSÖR VE TEKSTİL-SELÇUK BENLİ
Address of Manufacturer : DEFTERDAR MAH.MÜNZEVİ KIŞLA CAD.RIZA UZUN SOK.
NO:55 EYÜP/İSTANBUL
Label : SELKAS
Product : OVER SPEED GOVERNOR
Type :
Speed :
Serial Number :
Production Place : TÜRKİYE - İSTANBUL
Year of Production : 2019

We declare that our company applies a production quality system which fulfills the requirements of 2014/33/EU, EN 81-20:2015, EN 81-50:2015 and certified from MIRTEC CERTIFICATION – CE 0437.

EC – Type Examination Certificate No / Date : LF/KSA/A-C-0025/18

Notified Body : MIRTEC S.A. ID No:0437

SELKAS ASANSÖR VE TEKSTİL
Selçuk Benli
Defterdar Mahallesi Münzevi Kişla Caddesi
Rıza Uzun Sokak No:55/1 EYÜP/İSTANBUL
Bayramiye Şişe V.D. 1213821854
Ticaret Sicil No: 291828

CERTIFICATE of CONFORMITY to TYPE
According to Directive 2014/33/EU (Module C2)

Certificate No: LF/KSA/A-C-0024C/19

Name & Address
of the Certificate Holder :
of the Manufacturer:

**SELKAS MAKİNA ASANSÖR
 TİC. VE SAN. LİMİTED ŞİRKETİ
 DEFTERDAR MAH. RIZÂ UZUN SOK. NO:55A
 EYÜPSULTAN/ İSTANBUL / TÜRKİYE**

Date of sampling Examination:

03/05/2019

Number of EU Type-Examination Certificate:

MIRTEC, LF/KSA/A-C-0024/ 17

Number & Date of Report:

LF/KSA/A-R-0024C/19, 04/05/2019

Product Type of Safety Component:

**OVERSPEED GOVERNOR
 Type: KSLK/A3 , SLK/A3 , KSLK/KA3 , SLK/KA3,
 KSLK/DA3 , SLK/DA3**

Test Laboratory:

**SELKAS ASANSÖR – EYÜP, İSTANBUL
 (EU Type-examination)**

Surveillance Place:

**SELKAS ASANSÖR – EYÜP, İSTANBUL
 (Production Surveillance)**

Documents Annexed to this Certification:

**Product Description, Drawings, Installation &
 Maintenance Instructions, Material List, Material
 Certificate.**

DECLARATION

The manufacturer is -after examination of the prerequisites- authorized to provide his safety components (overspeed governor KSLK/A3 , SLK/A3 , KSLK/KA3 , SLK/KA3 , KSLK/DA3 , SLK/DA3) manufactured within the scope of the type examination our identification number to the CE mark as illustrated :



Date of issue:

04.05.2019 (Reissued on 31/05/2019)

Validity of the certificate:

04.05.2020

For MIRTEC S.A.

I. DIMITRIADIS
 Director of Athens Office



Certifying department for lifts

C. SPILIOPOULOS
 Inspector of Lifts

EBETAM A.E.
 CERT - safecomp / EN 03 (5.0 / 24.10.2016)
 AET-32586

www.ebetam.gr

Cooperative office in Istanbul: GCN - TÜRK ULUSLARARASI GÜZETİMBELGELENDİRME LTD. ŞTİRKİ Plaza - Tavukçesu Cad. Demirtürk Sok. No:15 Y. Dudullu / İstanbul / TÜRKİYE. Phone: +90 216 420 05 05 fax: +90 216 513 44 19 e-mail: sey@gcenter.com <http://www.gcenter.com>

Εξυπηλ. Κέντρο (Αθήνα): Πειραιώς 76, 115 47 Αθήνα - Athens Office: Πειραιώς 76, GR 115 47 Athens. Tel: +30 210 9944008. Fax: +30 210 9949830. E-mail: athens.office@ebetam.gr

Γραφείο Θεσσαλονίκης: Βασιλίσσης Όλγας 579 22 Θεσσαλονίκη - Θεσσαλονίκη Office: Industrial Area, GR 579 22 Thessaloniki. Tel: +30 2310 797827. Fax: +30 2310 723877. E-mail: thess.office@ebetam.gr

Παράρτημα Αθηνών: Ελ. Βενιζέλου 4, 157 06 Καλλιθέα - Athens Branch: Ελ. Βενιζέλου 4, GR 156 76 Kallithea. Tel: +30 210 9234932. Fax: +30 210 9236655. E-mail: athens.branch@ebetam.gr

Παράρτημα Ουζούμ: 30. Αβύσσου - Αγκυα: 110 8546, 54.06 Κοκκιές - Thess. Branch: 72 ομ. η Αθήνα - Lamasia R. P.O. Box 8546-GR 54120 Chalkidiki. Tel: +30 25622 780-3. Fax: +30 25622 7945. E-mail: thess.office@ebetam.gr

Εργαστήριο Αθηνών: Ηρώδου Φερού 92, 115 23 Πειραιάς - Athens Laboratories: Κηφισού 52, 115 25 Πειραιάς. Tel: +30 210 7283197. Fax: +30 210 2772858. E-mail: athens.lab@ebetam.gr

CERTIFICATE of CONFORMITY to TYPE
According to Directive 2014/33/EU (Module C2)

Certificate No: LF/KSA/A-C-0025C/19

Name & Address
of the Certificate Holder :
of the Manufacturer:**SELKAS MAKİNA ASANSÖR**
TİC. VE SAN. LİMİTED ŞİRKETİ
DEFTERDAR MAH. RIZA UZUN SOK. NO:55A
EYÜPSULTAN/ İSTANBUL / TÜRKİYE

Date of sampling Examination:

03/05/2019

Number of EU Type-Examination Certificate:

MIRTEC, LF/KSA/A-C-0025/ 17

Number & Date of Report:

LF/KSA/A-C-0025C/19, 04/05/2019

Product Type of Safety Component:

OVERSPEED GOVERNOR
Type: KSLK , SLK , KSLK/KM , SLK/M , KSLK/DM ,
SLK/DM , SLK/A

Test Laboratory:

SELKAS ASANSÖR – EYÜP, İSTANBUL
(EU Type-examination)

Surveillance Place:

SELKAS ASANSÖR – EYÜP, İSTANBUL
(Production Surveillance)

Documents Annexed to this Certification:

Product Description, Drawings, Installation &
Maintenance Instructions, Material List, Material
Certificate.**DECLARATION**

The manufacturer is -after examination of the prerequisites- authorized to provide his safety components (overspeed governor KSLK , SLK , KSLK/KM , SLK/M , KSLK/DM , SLK/DM , SLK/A) manufactured within the scope of the type examination our identification number to the CE mark as illustrated :

CE

Date of issue:

04.05.2019 (Reissued on 31/05/2019)

Validity of the certificate:

04.05.2020

For MIRTEC S.A.

I. DIMITRIADIS
Director of Athens Office**EBETAM A.E.**
CERT / safecomp / EN 03 (5.0 / 24.10.2016)
AET:32586

Certifying department for lifts

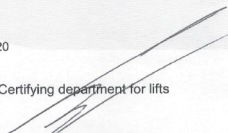
C. SPILIOPOULOS
Inspector of Lifts

www.ebetam.gr

Cooperative office in Istanbul: GEN - TÜRK ULUSLARARASI ÇÖZÜMLERLENDİRME LTD. Şİ. ANK. Plaza - Tavakıyolu Cad. Demirçirk Sok. No:15 Y. Dudullu /
İstanbul / TÜRKİYE. Phone: +90 216 429 95 90 fax: +90 216 313 44 19 e-mail: say@genark.com http://www.genark.com

Εθελοντ. Κέντρο Ερευνας Τεχνολογίας, Τ.Θ. 3, 385 00 Βόλος - Head Office: Α. Τριανταφυλίδης, Τ.Θ. Βοιά, Ο.Γ. 383 00 Βόλος, Τηλ.: +30 2420 90340-2, Fax: +30 242 919384, E-mail: volos.office@ebetam.gr
Γραφείο Αθηνών: Ηρώδης Πιπινός, Τ.Θ. 72 42 Αθήνα - Athens Office: Παναγιώτης Πιπινός, Τ.Θ. 073 42 Αθήνα, Τηλ.: +30 210 9961408, Fax: +30 210 9960800, E-mail: athens.office@ebetam.gr
Γραφείο Θεσσαλονίκης: Βουργαρέλι, Τ.Θ. 572 22 Θεσσαλονίκη - Θεσσαλονίκη Office: Industrial Area, Ο.Γ. 573 21 Θεσσαλονίκη, Τηλ.: +30 210 797987, Fax: +30 210 72367, E-mail: thess.office@ebetam.gr
Γραφείο Αθήνας: Ε. Βενιζέλου 4, 076 76 Κολίθρα - Athens Branch: Ε. Βενιζέλου, 4, Ο.Γ. 076 76 Κολίθρα, Τηλ.: +30 210 9235603, Fax: +30 210 9235603, E-mail: athens.branch@ebetam.gr
Γραφείο Θεσσαλονίκης: Τ.Θ. 310 Αθήνα - Αργυρά: Τ.Θ. 0846, 54 300 Χαλκίδα - Thess Branch: 72 km of Athens - Larisa N.R., P.O. Box 0846 Ο.Γ. 54 40 Χαλκίδα, Τηλ.: +30 22620 7981-8, Fax: +30 22620 7949, E-mail: thess.office@ebetam.gr
Εργοστάσιο Αθηνών: Αετός, Κ.Υ. 002-310, 10 33 Τεργεσία - Athens Laboratories: Κ.Παύλου 52, 10 33 Περαιάδα, Τηλ.: +30 210 2283707, Fax: +30 210 9770336, E-mail: athens.ltd@ebetam.gr

CERTIFICATE of CONFORMITY to TYPE
According to Directive 2014/33/EU (Module C2)

Certificate No: LF/KSA/A-C-0137C/19

Name & Address of the Certificate Holder : of the Manufacturer:	SELKAS MAKİNA ASANSÖR TİC. VE SAN. LİMİTED ŞİRKETİ DEFTERDAR MAH. RIZA UZUN SOK. NO:55A EYÜPSULTAN/ İSTANBUL / TÜRKİYE
Date of sampling Examination:	20/04/2017
Number of EU Type-Examination Certificate:	MIRTEC, LF/KSA/A-C-0137/ 17
Number & Date of Report:	LF/KSA/A-R-0137C/19, 4/05/2019
Product Type of Safety Component:	OVERSPEED GOVERNOR Type: PITFREE-S-UCM & PITFREE-UCM
Test Laboratory:	SELKAS ASANSÖR – EYÜP, İSTANBUL (EU Type-examination)
Surveillance Place:	SELKAS ASANSÖR – EYÜP, İSTANBUL (Production Surveillance)
Documents Annexed to this Certification:	Product Description, Drawings, Installation & Maintenance Instructions, Material List, Material Certificate.

DECLARATION

*The manufacturer is -after examination of the prerequisites- authorized to provide his safety
 type examination (overspeed governor PITFREE-S-UCM & PITFREE-UCM) manufactured within the scope of
 the type examination our identification number to the CE mark as illustrated :*

CE 0437

Date of issue: 4.05.2019 (Reissued on 31/05/2019)

Validity of the certificate: 4.05.2020

For MIRTEC S.A.

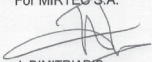
I. DIMITRIADIS
 Director of Athens Office

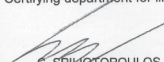

Certifying department for lifts

C. SPIROTOPOULOS
 Inspector of Lifts

EBETAM A.E.
 CERT - safecomp / EN 03 (5.0 / 24.10.2016)
 AET:27764

www.ebetam.gr

Cooperative office in Istanbul: GCN - TÜRK ULUSLARARASI GÖZETİM BELGELENDİRME LTD. ŞTİ. Akatlar Plaza - Tavakıyazısı Cad. Demirtürk Sok. No:15 Y. Dudulu /
 İstanbul / TÜRKİYE Phone: +90 216 428 08 08 fax: +90 216 313 44 19 e-mail: acay@gcntrk.com <http://www.gcntrk.com>

Επίσημο Α' Βραβείο στην Πρώτη θέση, Τ.Θ. 3, 385 00 Βόλος - Head Office: A' Indus. z. Area, P.O. Box 03, GR 385 05 Volo, Tel.: +30 2420 95340-2, Fax: +30 2420 05564, E-mail: volos.office@ebetam.gr
 Γραφείο Αθήνας: Παιονίας (Παράρτητο) 76, 73 42 Αθήνα - Athens Office: Paflos Perikouli 76, GR 175 42 Athina, Tel.: +30 210 7496938, Fax: +30 210 7496950, E-mail: athens.office@ebetam.gr
 Γραφείο για Αθήνας Ελ. Ιεροσόλων 4, (Νέο 76) Κολλίτιο - Athens Branch: EL. Venizelou, 4, GR 176 76 Kolititha, Tel.: +30 210 9234932, Fax: +30 210 9235603, E-mail: athens.branch@ebetam.gr
 Γραφείο για Θεσσαλονίκη Ε.Ο. Αθηνών - Αττικής, Τ.Θ. 8645, 541 00 Θεσσαλονίκη - Thessalon Branch: 72 km of Athens - Lemna N.R., P.O. Box 0646 GR 54100 Thessalon, Tel.: +30 25620 798-05, Fax: +30 25620 7949, E-mail: thess.office@ebetam.gr
 Εργαστήριο Αθηνών: Αττικής, Κηφισού 30, 11533 Γλυφάδα - Athens Laboratories: K. Fassoou 50, 01 33 Peristeri, Tel.: +30 210 2285737, Fax: +30 210 2773550, E-mail: athens.lab@ebetam.gr

CERTIFICATE of CONFORMITY to TYPE
According to Directive 2014/33/EU (Module C2)

Certificate No: **LF/KSA/A-C-0154B/19**

Name & Address of the Certificate Holder : of the Manufacturer:	SELKAS MAKİNA ASANSÖR TİC. VE SAN. LİMİTED ŞİRKETİ DEFTERDAR MAH. RIZA UZUN SOK. NO:55A EYÜPSULTAN/ İSTANBUL / TÜRKİYE
Date of sampling Examination:	03/05/2019
Number of EU Type-Examination Certificate:	MIRTEC, LF/KSA/A-C-0154/ 17
Number & Date of Report:	LF/KSA/A-R-0154B/19, 04/05/2019
Product Type of Safety Component:	OVERSPEED GOVERNOR Type: PITFREE-S & PITFREE-S-M & PITFREE & PITFREE-B-M
Test Laboratory:	SELKAS ASANSÖR – EYÜP, İSTANBUL (EU Type-examination)
Surveillance Place:	SELKAS ASANSÖR – EYÜP, İSTANBUL (Production Surveillance)
Documents Annexed to this Certification:	Product Description, Drawings, Installation & Maintenance Instructions, Material List, Material Certificate.

DECLARATION

The manufacturer is -after examination of the prerequisites- authorized to provide his safety components (overspeed governor PITFREE-S, PITFREE-S-M & PITFREE, PITFREE-B-M) manufactured within the scope of the type examination our identification number to the CE mark as illustrated :

CE 0437

Date of issue: 04.05.2019 (Reissued on 31/05/2019)

Validity of the certificate: 04.05.2020

For MIRTEC S.A.

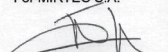
I. DIMITRIADIS
Director of Athens Office

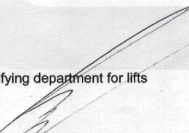

Certifying department for lifts

C. SPILIOPOULOS
Inspector of Lifts

EBETAM A.E.
CERT - safecomp / EN 03 (5.0 / 24.10.2016)
AET:32586

www.ebetam.gr

Cooperative office in Istanbul: GCN - TÜRK ULUSLARARASI GÖZETİM BELLENDİRME LTD. ŞTİ.ANK Plaza - Tavşanlı Cad. Demirtürk Sok. No:15 Y. Dubulu / İstanbul / TÜRKİYE. Phone: +90 216 429 99 88 Fax: +90 216 313 44 19 E-mail: icp@gratirk.com <http://www.gratirk.com>

Επίσημο Αθηνών Γραφείο: Μεσογείων 76, 073-02 Αθήνα - Athens Office: Melissas Merkouris 76, GR 073-02 Athens, Tel.: +30 210 9966138. Fax: +30 210 9596832. E-mail: athens.office@ebetam.gr

Επίσημο Θεσσαλονίκης Βιομηχανικών Υπηρεσιών, 570 22 Θεσσαλονίκη - Thessaloniki Office: Industrial Area, GR 570 22 Thessaloniki, Tel.: +30 210 797987. Fax: +30 210 72157. E-mail: thess.office@ebetam.gr

Παράρτημα Αθηνών: Ελ. Βενιζέλου 4, 06 76 Καλλιθέα - Athens Branch: EL Venizelou 4, GR 06 76 Kallithea, Tel.: +30 210 9234932. Fax: +30 210 9336603. E-mail: athens.branch@ebetam.gr

Παράρτημα Θράκης: 730 π.μ. ΕΟ Αθήνας - Λαμία, Τ.Θ. 3846, 341 00 Χαλκίδα - Thiva Branch: 72 km of Athens - Larnia N.R. P.O. Box 1846 GR 341 00 Chalkida, Tel.: +30 22820 781-85. Fax: +30 22820 7744. E-mail: thiva.office@ebetam.gr

Εργαστήριο Αθηνών: Λαύρα, Ουρανούπολι 50, 1133 Παράδεισοι - Athens Laboratories: Olyssou 50, 1133 Parositi, Tel.: +30 210 7283751. Fax: +30 210 5770558. E-mail: athens.lab@ebetam.gr